

7111 Tradeport | 7111 Tradeport Dr, Louisville, KY

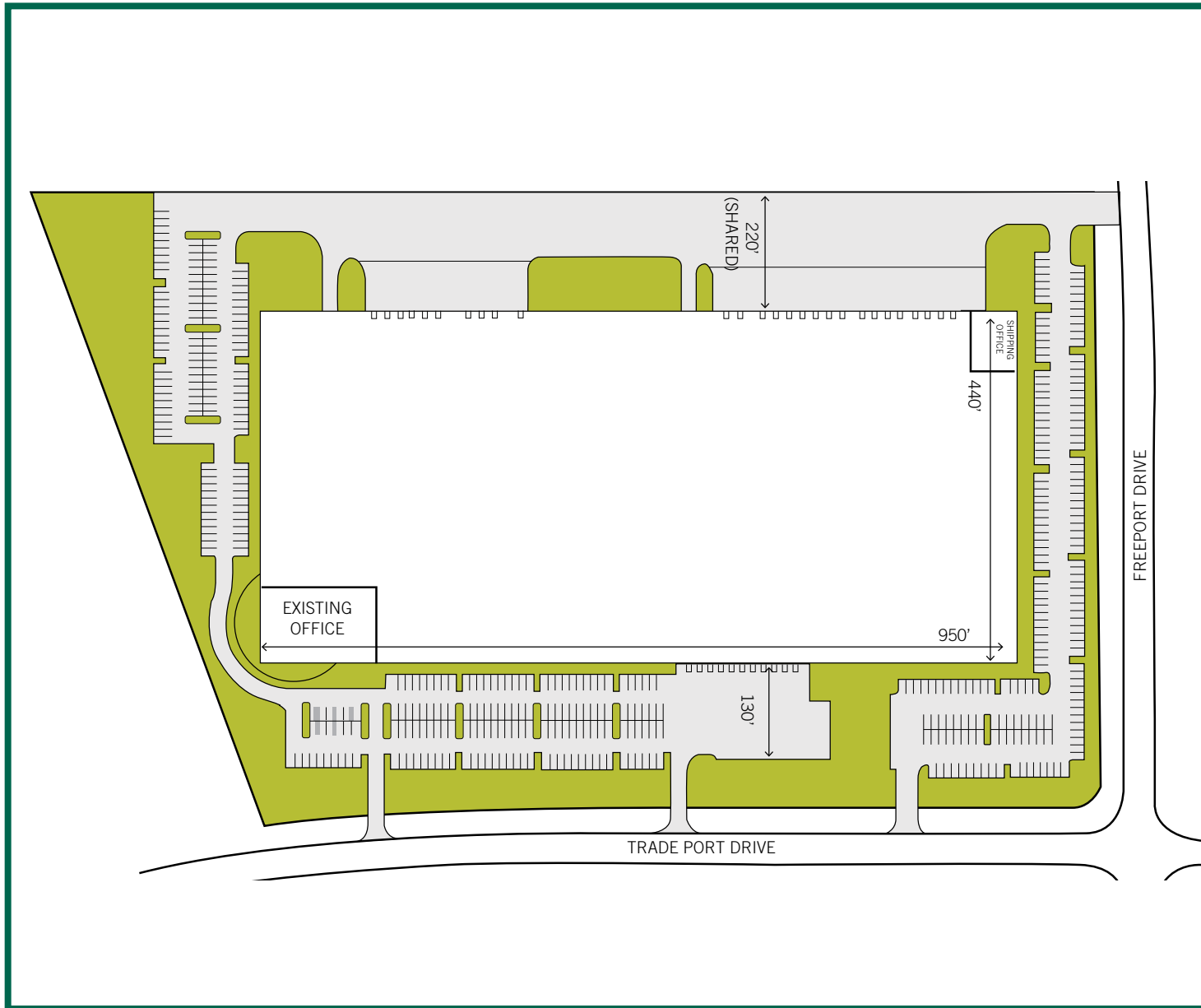

BUILDING DETAILS

Property Overview

Total GLA	419,088 sq. ft.
Year Built / Renovated	1998 / 2015
Office Space	14,195 sq. ft. (Expansion-1,280 sq. ft.)
Trailer Parking	n/a
Car Parking Spaces	482

Space Available

100% Fully Leased

- Leased
- Vacant